

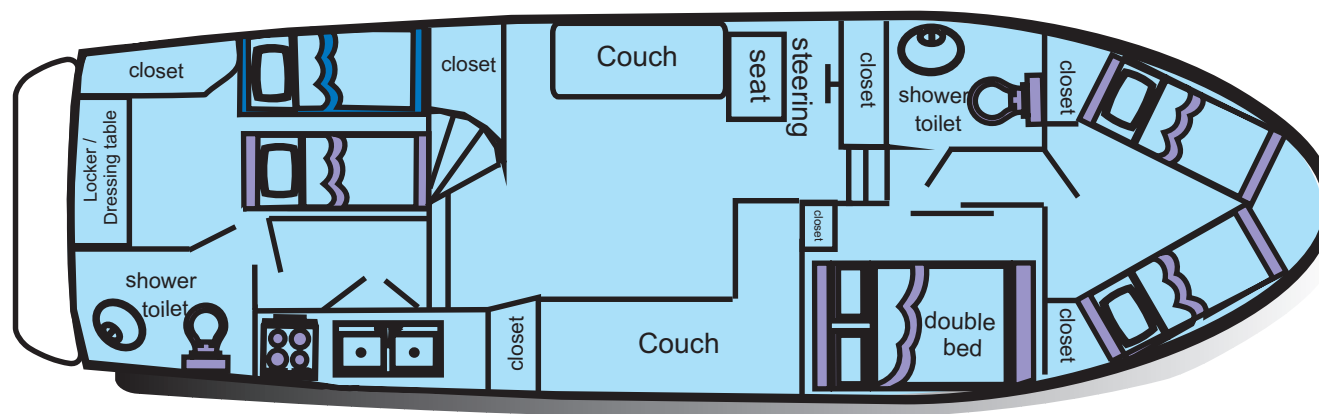

# Wavequeen

6-8-berth, ideal for three couples or a family

4 separate cabins, 2 toilets with sink and shower,  
large galley with 4-ring hob and oven (gas) & fridge (12V),  
radio/CD/MP3, 12-V-cigarette lighter sockets,  
220V inverter, hot water supply,  
hot air heating, 2nd steering outside (flybridge), sun deck,  
Built: 1998/99



## Specifications

Length:	11,30m
Beam:	3,65m
Draft:	0,90m
Airdraft:	2.80m
Engine:	Perkins M90
Gearbox:	Borg-Warner
Diesel:	approx 225 ltrs
Water:	approx 360 ltrs
Waste water:	approx 270 ltrs

# €108.000

inc @ VAT 21.5%